

## Timber Stud Partition system type – **Timber (Non-loadbearing)**

Product Substantiation Report (PSR) reference – **Q026021**

### **Performance characteristics**

Partition Fire Resistance (BS 476):	<b>30 minutes</b>
Permissible load ratio (after fire resistance period):	<b>100%</b>
Partition Laboratory Sound Resistance (BS EN 717):	<b>36 R<sub>w</sub>dB</b>
Partition nominal thickness (excluding finishes):	<b>102mm</b>

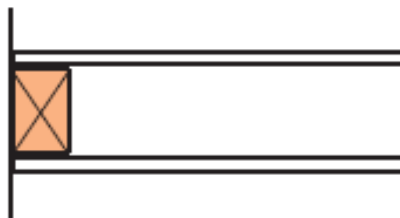

### **Framing components**

Minimum timber stud size:	<b>75mm x 38mm</b>
Stud centres:	<b>600mm</b>

(Minimum stud size quoted above required to satisfy stated fire resistance performance criteria, larger stud sizes may be specified to meet structural height requirements. Timber stud sizes to satisfy structural partition criteria must be specified by others)

Acoustical sealant:	<b>Gyproc Sealant applied around perimeter to both sides of partition framework</b>
---------------------	---

Drawing references:	Refer to relevant Architects drawings
---------------------	---------------------------------------

### **Plasterboard components**

Number of plasterboard layers each side:	<b>1</b>
Gyproc plasterboards:	Layer 1 (Inner): <b>13.5mm Gyproc DuraLine</b>
	Layer 2: n/a
	Layer 3: n/a
Screw fixings for boarding:	Layer 1 (Inner): <b>40mm Gyproc Drywall Timber Screws</b>
	Layer 2: n/a
	Layer 3: n/a

- All board joints installed staggered in accordance with Gyproc's current installation recommendations.
- Vertical Joints in face layer boards treated in accordance with **Gyproc Paper Joint Tape** method.
- Horizontal joints in face layer boards to be backed with horizontal timber noggings or Gypframe GFS1 Fixing Strap and treated in accordance with **Gyproc Paper Joint Tape** method.
- Gyproc DryWall Timber screws installed at 300mm centres (200mm at external corners)

- Gyproc DryWall Timber screws must maintain a minimum 25mm penetration into timber framing components.

### **Insulation components**

Insulation specification required in stud cavity: n/a

### **Finishing**

2mm **Gyproc Skimcoat** plaster (or **Carlite Finish**) applied in accordance with Gyproc's current recommendations.

Or

1 coat of **Gyproc Drywall Primer** prior to direct decoration (applied as soon as possible after board fixing is completed).

### **Qualifications**

All materials unless otherwise indicated shall be supplied by Gyproc, and shall be installed in accordance with their current published instructions and generally in accordance with all relevant Standards. Systems installed in full accordance with Gyproc's recommendations comprising of genuine Gyproc and Isover branded components qualify for the SpecSure lifetime system warranty.



### **Health & Safety**

Ensure that suitable personal protection is worn when handling Gyproc and Isover products/systems. All relevant Health and Safety Legislation and Guidelines must be followed. The relevant Material Safety Data Sheets must be referred to prior to specifying, handling or installing Gyproc & Isover products and systems.

### **Installation**

For full installation assistance refer to Gyproc Systems Solutions and Installation Guide literature which is available at [www.gyproc.ie](http://www.gyproc.ie). Alternatively contact the Technical Service department at 1800 744480 (RoI) or 0845 3990159 (NI). Full specification, detailing and site support can be offered for your project specific requirements.

### **Manufacturer**

Gyproc, Unit 4 Kilcarbery Business Park, Nangor Road, Dublin 22, Ireland